



CPVC STRAP

Two Hole Model 1080

SIZE:

3/4" thru 2" CPVC pipe

FINISH:

Electro-Galvanized

FUNCTION:

The CPVC Two Hole Pipe Strap is designed to support pipe running horizontally on side of beam or as a guide to mount CPVC Pipe running perpendicular across the top of beam or on a vertical run. Model # 1070 may be installed onto wood using supplied fastener or into minimum 20 guage steel using two (2) 1/4" x 1 tek type screw.

FEATURES:

- Flared edges protect the CPVC piping
- Retainer dimples secure hanger to pipe during installation
- Attaches easily to wood structure with two #10 x 1" hex head screws
- Strap has one (2) 1/4" diameter hole for mounting
- Optional: 1/4" x 1" tek type screw for mounting to steel (sold seperately)
- Strap is UL listed for US and Canada

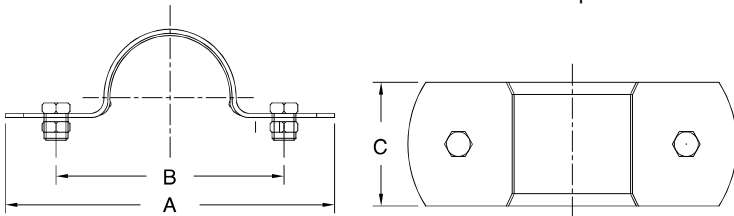

CPVC Strap: Loads (LBS) • Weights (LBS) • Dimensions (IN)

ITEM CODE	PIPE SIZE	MAX SPACING	WEIGHT	A	B	C	D NOMINAL PIPE SIZE
1080-075EG	3/4	5'-6"	.075	3 1/4	2 1/4	1 3/16	1.05
1080-100EG	1	6'-0"	.082	3 1/2	2 1/2	1 3/16	1.315
1080-125EG	1 1/4	6'-6"	.094	4 1/4	3 1/4	1 3/16	1.66
1080-150EG	1 1/2	7'-0"	.104	4 7/16	3 7/16	1 3/16	1.90
1080-200EG	2	8'-0"	.119	4 15/16	3 15/16	1 3/16	2.375