



## RISER CLAMP

### Standard Riser Clamp Model 6400

**SIZE:**

Range: 1/2" thru 4"

**FINISH:**

Copper-Colored Epoxy (PC)

**MATERIAL:**

Carbon steel

**FEATURES:**

- Maximum temperature Plain 650° F, Galvanized 450° F
- Designed for standard iron pipe
- Complies with Federal Specifications A-A-1192A (Type 8), WW-H-171-E (Type 8), ANSI/MSS SP-69 AND MSS SP-58 (Type 8)

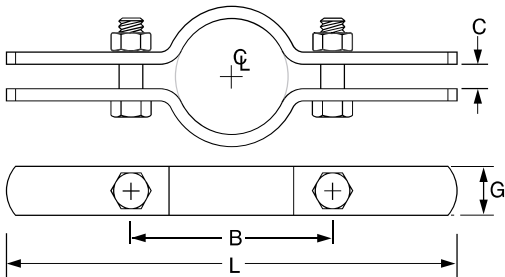

**Riser Clamp - PC:**

**Loads (LBS) • Weights (LBS) • Dimensions (IN) • Torque Values (FT-LBS)**

ITEM CODE 6400	TUBE SIZE	MAX LOAD	WEIGHT	L	G WIDTH	BOLT SIZE	TORQUE VALUES
6400-0050PC	1/2"	75	0.63	9	1 3/16	3/8	19
6400-0075PC	3/4"	75	0.65	9	1 3/16	3/8	19
6400-0100PC	1"	120	0.70	9	1 3/16	3/8	19
6400-0125PC	1 1/4"	150	0.72	9	1 3/16	3/8	19
6400-0150PC	1 1/2"	150	1.08	10	1 3/16	3/8	19
6400-0200PC	2"	150	1.19	10 1/4	1 3/16	3/8	19
6400-0250PC	2 1/2"	300	1.23	11	1 3/16	3/8	19
6400-0300PC	3"	300	1.34	11 3/4	1 3/16	3/8	19
6400-0400 PC	4"	300	1.71	12 1/2	1 1/4	3/8	50