



PIPE HANGERS





 UL: 1/2" thru 8"
 FM: 3/4" thru 8"
 Model 3000

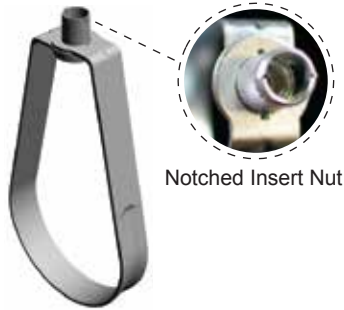

Notched Insert Nut

LOOP HANGER

Nominal Pipe Size Loop Hanger Model 3000, 3200-VC, 3500-SS

SIZE:

1/2" thru 8"

FINISH:

Electro-Galvanized & Black vinyl coating & Stainless Steel

FUNCTION:

Recommended for the suspension of stationary non-insulated pipe lines

FEATURES:

- A keyed insert nut to ensure that the loop hanger and insert nut stay together
- Insert nut can be removed if required
- Complied with Federal Specification A-A-1192A (Type 10) and MSS SP-69 (Type 10)
- NFPA standards for reduced rod sizes for Electro Galvanized only
- UL Approval for use with CPVC pipe
- SS Loop Hangers come without Insert Nut

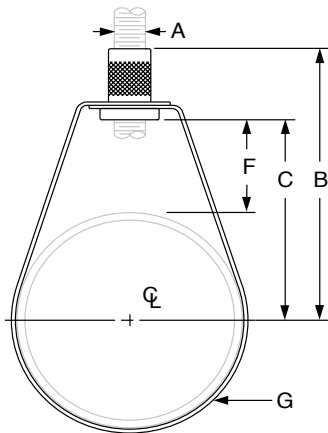

Loop Hanger: Loads (LBS) • Weights (LBS) • Dimensions (IN)

PIPE SIZE	MAX LOAD	WEIGHT	A ROD SIZE	B	C	F	G WIDTH
1/2	300	0.10	3/8	27/16	17/16	11/16	5/8
3/4	300	0.10	3/8	211/16	111/16	11/8	5/8
1	300	0.10	3/8	213/16	113/16	11/8	5/8
1 1/4	300	0.11	3/8	27/8	17/8	11/16	5/8
1 1/2	300	0.11	3/8	3	2	11/16	5/8
2	300	0.14	3/8	33/16	23/16	11/16	5/8
2 1/2	300	0.19	3/8	49/16	35/16	17/8	7/8
3	1000	0.23	3/8	5	33/4	2	7/8
3 1/2	1000	0.23	1/2	5	33/4	2	7/8
4	1000	0.30	3/8	6	411/16	23/8	7/8
5	1000	0.50	1/2	6 1/2	5 1/4	27/16	3/4
6	1250	0.58	1/2	7 3/4	63/16	27/8	3/4
8	1250	0.90	1/2	9 5/16	711/16	33/8	7/8