

# Give us a call today....

we have one boxed and ready for you!

## 1.877.213.7130

## PBOXHM-134

### NEW PRODUCT

### 4" ROUND CEILING PVC HALF-MOON BOX



2 hour fire-rated

#### FEATURES:

PBOXHM-134 New Construction non-metallic support box allows you to safely attach a lighting fixture or ceiling fan to a building's structural support, so the ceiling fan is supported by the joist, not the box. It can be installed on standard joists as well as wider joist configurations where a saddle style box will not fit. It provides additional wiring space in one place, on the side, so all of the fan or fixture wiring will fit inside the box without having to split wires due to limited space.

PBOXHM-134(CFB-1) has been tested, investigated and found to comply with the requirements of the Standard(s) for Non-Metallic Outlet Boxes, Flush-Device Boxes & Covers (UL-514C) and are identified with the ETL Listed Mark

- Ideal for new construction for ceiling fans of any style
- 4" box height X 1/2" box depth, 13.4 cubic inch wiring capacity
- Includes mounting hardware & Instruction sheet
- Includes a cap to protect inner workings during drywall installation or painting
- Supports fans up to 70 Lbs.
- Supports lighting fixtures up to 150 Lbs.
- ETL listed in accordance with UL-514C
- ETL 2 hour fire rated
- The boxes are intended to be installed in accordance with ANSI/NFPA 70, "National Electrical Code."

PART NUMBER	DESCRIPTION	BOX QTY	BOX WEIGHT KG	Pallet Quantity
PBOXHM-134	13.4 Cu In New Work NM Half-Moon Support Box with mounting hardware	100	15	1800

WARNING This product can expose you to chemicals including lead, which is known to the State of California to cause cancer, and which is known to cause birth defects or other reproductive harm. For more information, go to [www.P65Warnings.ca.gov](http://www.P65Warnings.ca.gov).



12600 CARDINAL MEADOW SUITE 108 • SUGAR LAND, TX 77498  
O: 281.494.3999 • F: 281.494.0950 • T: 1.877.213.7130



WWW.ELITECOMPONENTS.COM



SUBJECT TO CHANGE WITHOUT NOTICE. GO TO WEB SITE FOR MOST CURRENT PRODUCT INFORMATIONS AND CHANGES OR CONTACT ELITE COMPONENTS SALES REPRESENTATIVE FOR ANY ASSISTANCE.

ELITE COMPONENTS © 2020

ELITE's PBOXHM-134 has been tested, investigated and found to comply with the requirements of the Standard(s) for Non-Metallic Outlet Boxes, Flush-Device Boxes & Covers (UL-514C) and are identified with the ETL Listed Mark with 2-HR Fire rating. It supports fan weighing up to 70 lbs. and light fixtures weighing up to 150 lbs.

## **FAN ATTACHES TO WOOD JOIST & NOT TO NON-METALLIC BOX**

### **Instructions**

- a. Ensure the electrical power is off before installation.
- b. Pull wires into the box & attach the box to the wood joist. Install the screw in the center of the hole first.(Figure 1)
- c. For new construction application, stick wires into the box and put white colored cap on. The cap protects wiring during sheet rocking.(Figure 2)
- d. Once the ceiling work is complete, remove the cap and install fan mounting bracket(should be provided with the fan) using two mousing screw provided. (Figure 3)
- e. Complete the fan installation and wiring in accordance with fan or fixture manufacturer's instruction.

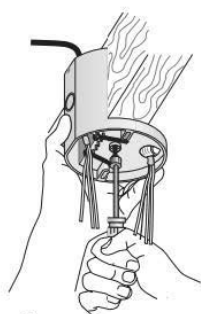

**Figure 1**



**Figure 2**

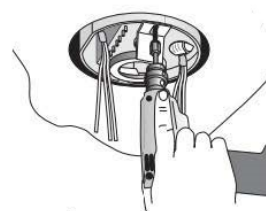

**Figure 3**